

DPNR-CCZP
RECEIVED BY: *Freigfalle*
RECEIVED DATE:

7-24-2024

(SITE OF FUTURE
CRICKET FIELD)
CURRENT
ZONING: R-2
Remainder of
Parcel N of Tract 1
(refer to A9-671-7010)

Parcel N-1-Remainder of Tract 1
5.032 Acres
(D9-9848-T024)
CURRENT
ZONING: R-2
P-PUBLIC
PROPOSED

(W.M.A. BIN SITE)
CURRENT
ZONING: R-2
Remainder of
Parcel N of Tract 1
(refer to A9-671-7010)

Parcel N-1-1 of Tract 1
4.152 Sq. Ft. ±
0.095 Acres
(D9-9848-T024)
(NOT PART OF PROJECT)

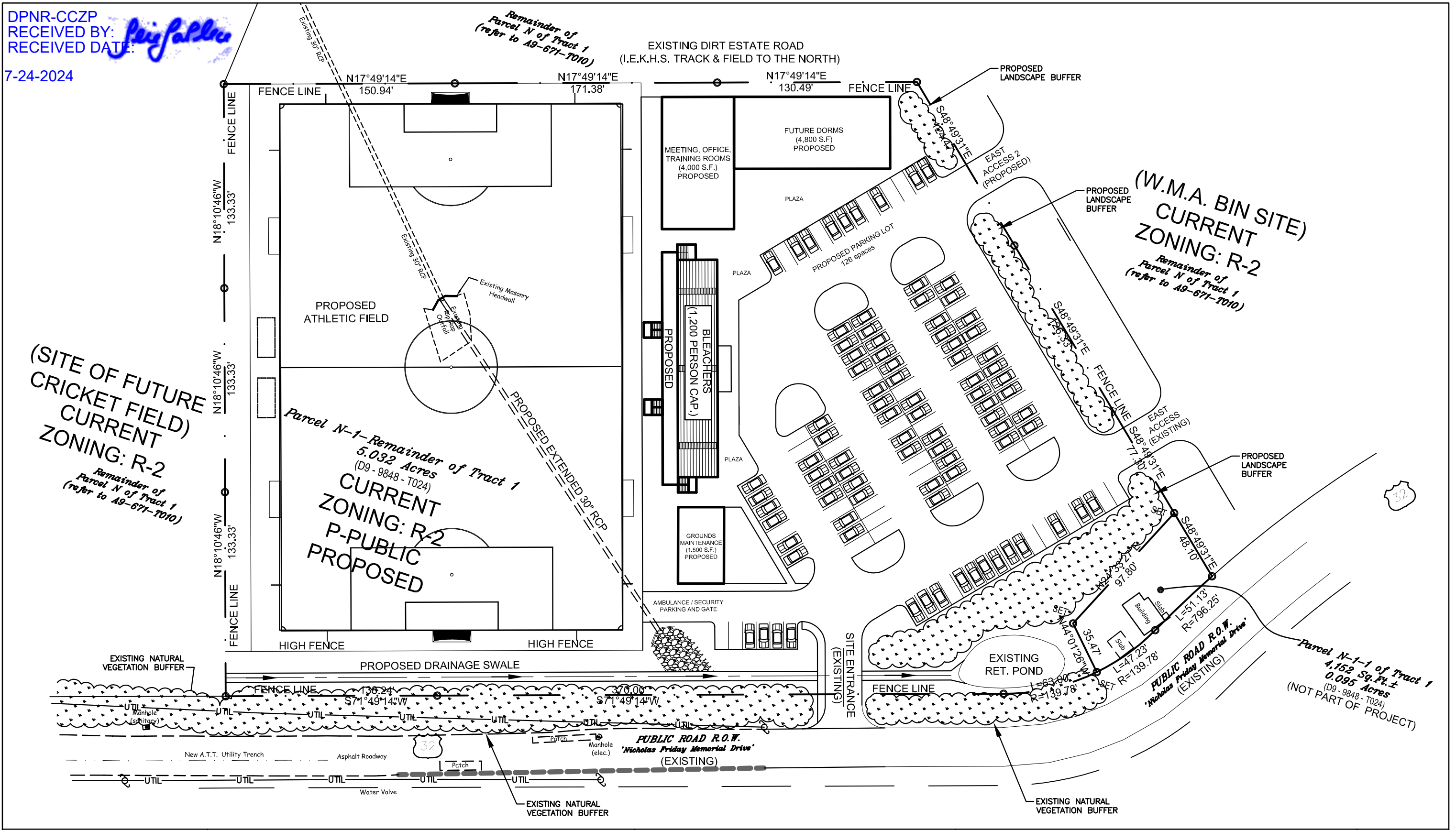

PREPARED BY:
BOSCHULTE
ARCHITECTURE

REZONING CONCEPT SITE PLAN

PROJECT LOCATION:
**PCL. NO. N-1-REM.
ESTATE NAZARETH
ST. THOMAS, U.S.V.I.**

ATHLETIC FIELD

SCALE:
1"=60'

DATE:
7/24/2024

C-1