

PROPOSED STORAGE WAREHOUSE FOR
CARVELL A. & COLETTE A. ROGERS, ANTHONY & JACKLIN I., ROGERS,

DRAWN BY: ERIC MUSSENDE

SCALE: 1' = 20ft.

CHECKED BY:

DATE: JUL. 10 2024

PARCEL NO. 41-5-1 FRYDENHOJ.
NO.3 RED HOOK QUARTER ST. THOMAS, V.I.

1

REFERENCE TO D.L.G. FILE No. G9-658-T62

2

PUBLIC ROAD.

146.0'±

PARCEL No. 41-5-1
AREA = 0.30 AC

PROPOSED
PARKING AREA

PROPOSED SECOND LEVEL
STORAGE WAREHOUSE

PCL No. 41-5-2.

N 07°00' 00" E
82.70'

10.0'

222.0'±

ESTATE ROAD.

SITE PLAN

41-5-1 ESTATE FRYDENHOJ

65'-0"

4'-0"

25'-0"

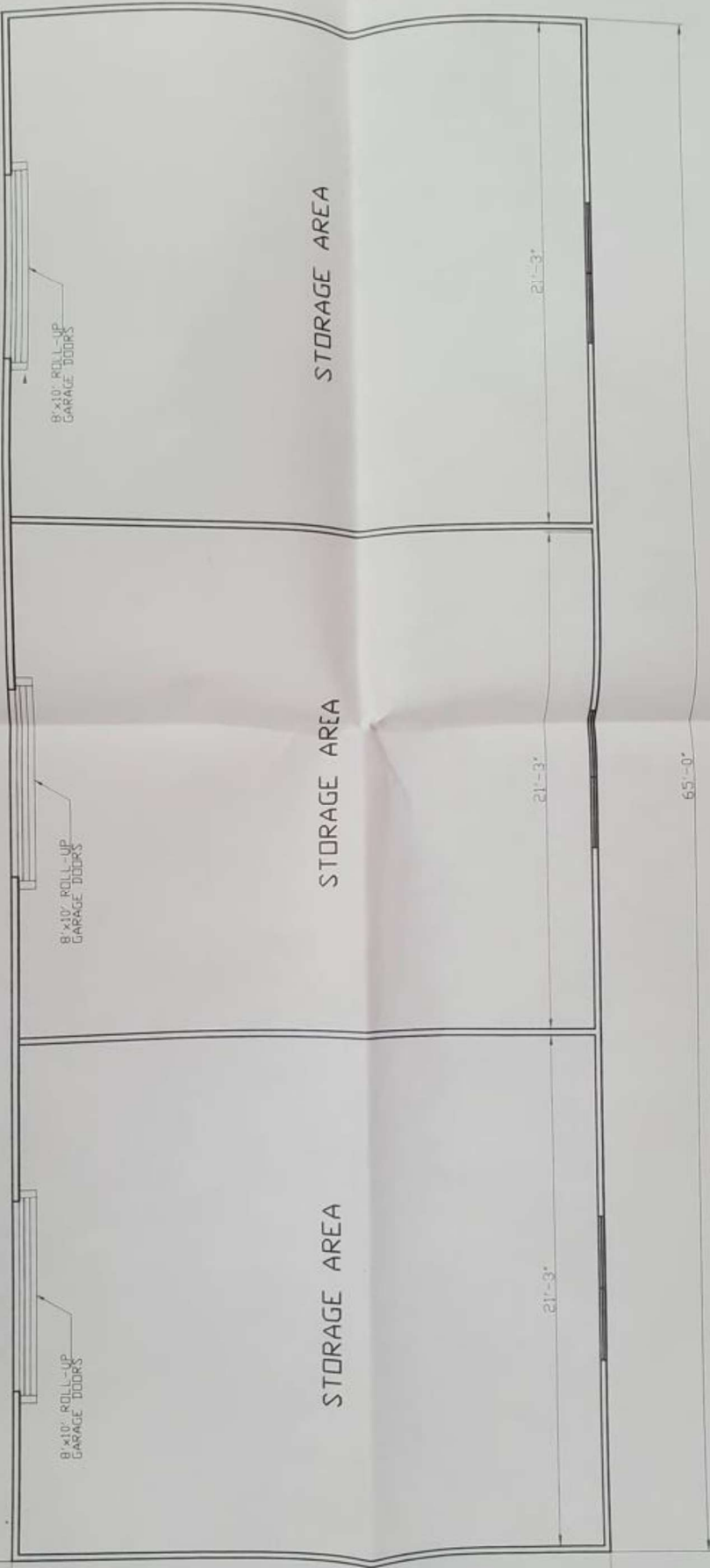

8' x 10' ROLL-UP GARAGE DOORS

8' x 10' ROLL-UP GARAGE DOORS

8' x 10' ROLL-UP GARAGE DOORS

STORAGE AREA

STORAGE AREA

STORAGE AREA

21'-3"

21'-3"

21'-3"

65'-0"

WAREHOUSE PLAN
SCALE: 1/4" = 1'-0"